

H194X-00F05

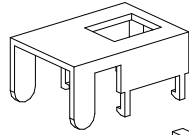

SHAFT-00038



H194X-MT003



H194X-MT006

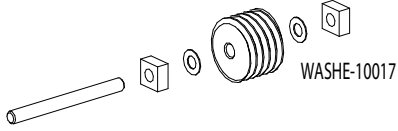

WASHE-10017

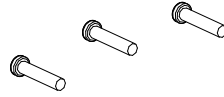

H194X-00H01

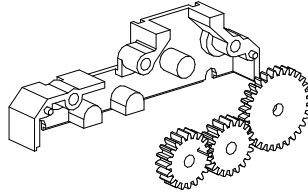

H194X-00L03

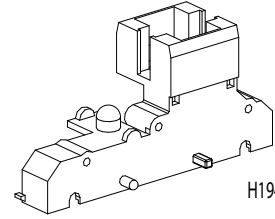

H194X-00H02

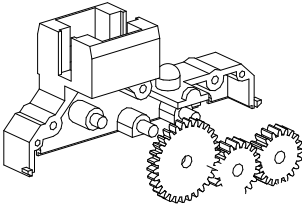

H194X-00L02

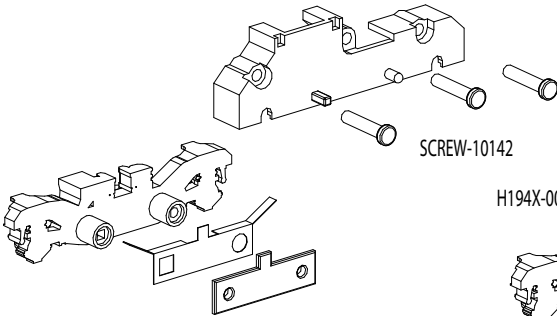

SCREW-10142

H194X-00N02

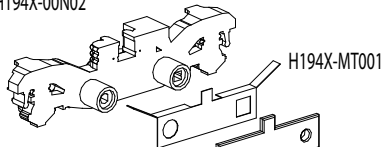

H194X-MT001

H194X-00J01



H194X-00L01



SHAFT-10179

L1062-00E01

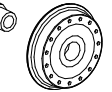

H194X-00E07

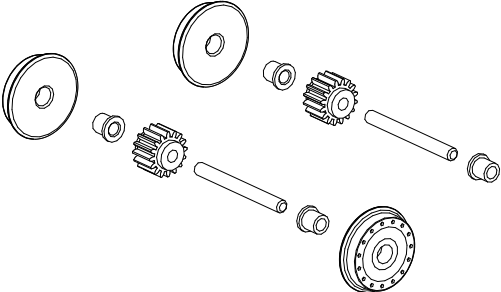

H194X-00E03

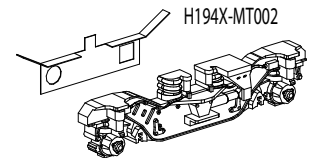
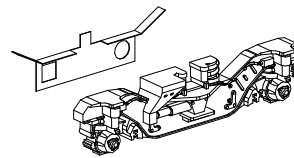
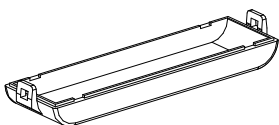
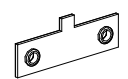

H194X-MT002

H194X-00N01

## HO Acela HHP-8 Instruction :

- 1) To open the body shell
  - a) Remove the body shell by gently pulling the bottom sides out and lifting the shell (see diagram B).
- 2) To operate from track/pantographs power (see diagram A and B)

Gently remove the roof vent cover (see diagram B) ,

  - a) To operate from track power , set the switch to " TRACK " (default) .
  - b) To operate from pantographs power , set the switch to " ANT " .
- 3) For digital command control (D.C.C) (optional) , see diagram A and B .
  - a) Remove the body shell ,OR remove the roof vent cover ,
  - b) Simply remove the dummy plugs and install the D.C.C compatible decoder (see diagram A).

